

LED Track System



LED Track System



A very small LED track designed for use in cabinets and display areas with a clever, patent applied for, 'click in' spotlight connection system.

This system enables the correct series connection to be maintained at every spotlight, and as many spotlights fitted as the power supply will allow.

The track section is a slim soft elliptical shape which, with the addition of a purpose designed fixing bracket, will fit neatly into the corners of cabinets, and can be freestanding or suspended.

The connection system features the novel use of a jack plug and socket and it's these components that ensure the vital series connection is maintained, and that however many spotlights are fitted to the track, they are all operating at the optimum current.



Attaching the spotlights is a simple matter, with a sliding movement the jack clicks into place. The section is very small as the drawing (approx. actual size) below shows. The spotlights are designed for one or two watt Luxeon™ LEDs - although these must not be mixed on the same track.

The track modules can be joined electrically with a loop connector, so that total length is only dependent on the size of driver and the number of spotlights fitted. Freestanding 'goalpost' and vertical mounting attachments are also available.

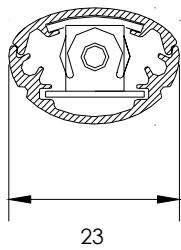

Track section

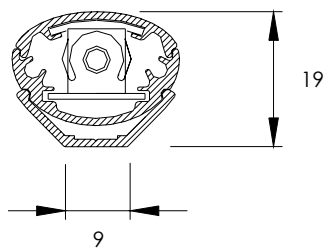

Track section with fixing bracket



The system is perfect for cabinet lighting and retail display areas.

Track Modules

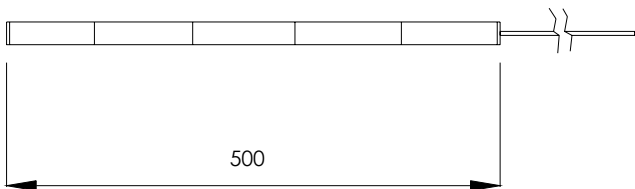

CLT 0500 S

A 500mm long track module with fitted end caps, 1.5 metres of cable, 5 blanking plates and 2 fixing clips. A maximum of 5 spotlights can be fitted.

Anodised aluminium alloy.

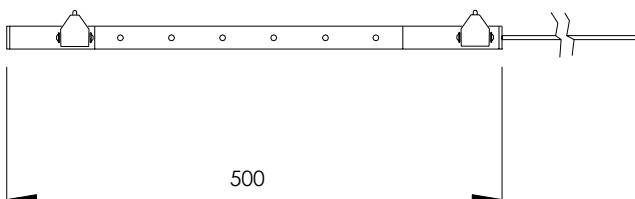

CLT 0510 S

A 500mm long track module with a CLTF8001 spotlight at either end and 6 unlened Luxeon LEDs in the centre to provide wash lighting.

Anodised aluminium alloy.

Spotlights

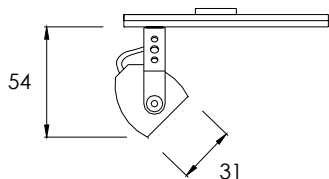

CLTF8001 Spot
 1w Luxeon™ LED
 Anodised Aluminium Alloy
 Angular and rotational adjustment

CLTF8002 Spot
 As above but 2w Luxeon™ LED

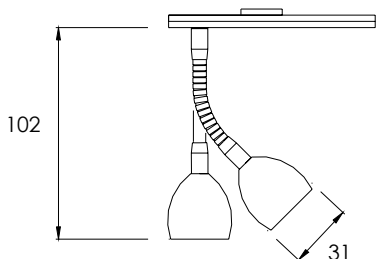

CLTF8051 Flex Spot
 1w Luxeon™ LED
 Anodised Aluminium Alloy
 Angular and rotational adjustment

CLTF8052 Flex Spot
 As above but 2w Luxeon™ LED

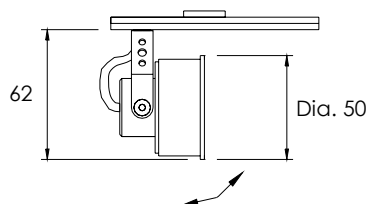

CLTF8025 Triple Spot
 3 x 1w Luxeon™ LED
 Anodised Aluminium Alloy
 Angular and rotational adjustment

Choose the full specification for the spotlight required as follows:

CLTF **XXXX** **X** **XXX** **XX**

LED Colour: **WH** - white **WW** - warm white
RE - red **BL** - blue **YE** - yellow **GR** - green

Lens: **LNL** - no lens **L06** - 6° lens **L15** - 15° lens
L25 - 25° lens **LOV** - oval lens (8x25°)

Finish: **S** = Silver **X** = Special, please state quantity
 (minimum quantity will apply).

Design Number: EG: 8001

Accessories



CLTA8201 Horizontal Mounting Kit
 Two tubular uprights, with mounting flanges and attachments to take the standard track modules. Standard height 500mm – can be cut down on site.



CLTA8211 Vertical Mounting Kit
 An attachment to take the standard track modules and mount vertically. Allows for rotational adjustment.

CLTA8221 Wire Link
 Electrically connects two track modules.

Drivers

CRE2777
 Will power a 350mA system with up to 8 x 1w spotlights.

CRE2784
 Will power a 700mA system with up to 4 x 2w spotlights.



Crescent are members of the Luxeon Lighting Network, Luxeon Certified Luminaire Manufacturers and use the Luxeon Star™ throughout the product range.

Crescent lighting reserves the right to change the specification of products without prior notice.

© Copyright Crescent Lighting Limited 2006

Crescent Lighting Limited, 8 Rivermead, Pipers Lane, Thatcham, Berkshire, RG19 4EP
Telephone: +44 (0)1635 878888 Facsimile: +44 (0)1635 873888
email address: sales@crescent.co.uk

www.crescent.co.uk

